



Anna Drop-side Cot

For your new world



Assembly and care instructions

IMPORTANT RETAIN FOR FUTURE REFERENCE: READ CAREFULLY

Thank you for purchasing an East Coast product. It's been carefully designed and constructed to offer quality, safety and reliability for you and your baby.

If you have a query about this product or require replacement parts, please contact 01692 408802.

Your child's safety is your responsibility. Keep children clear during assembly as the fittings pack contains small parts which may present a choking hazard. Please read the instructions and warnings carefully before use.

Lay out the parts on a soft level surface and compare to the parts checklist. Don't throw away any packaging until you're sure that you have all the parts.

You will need the following tools to complete assembly:

Flat-headed screwdriver.

Cot parts

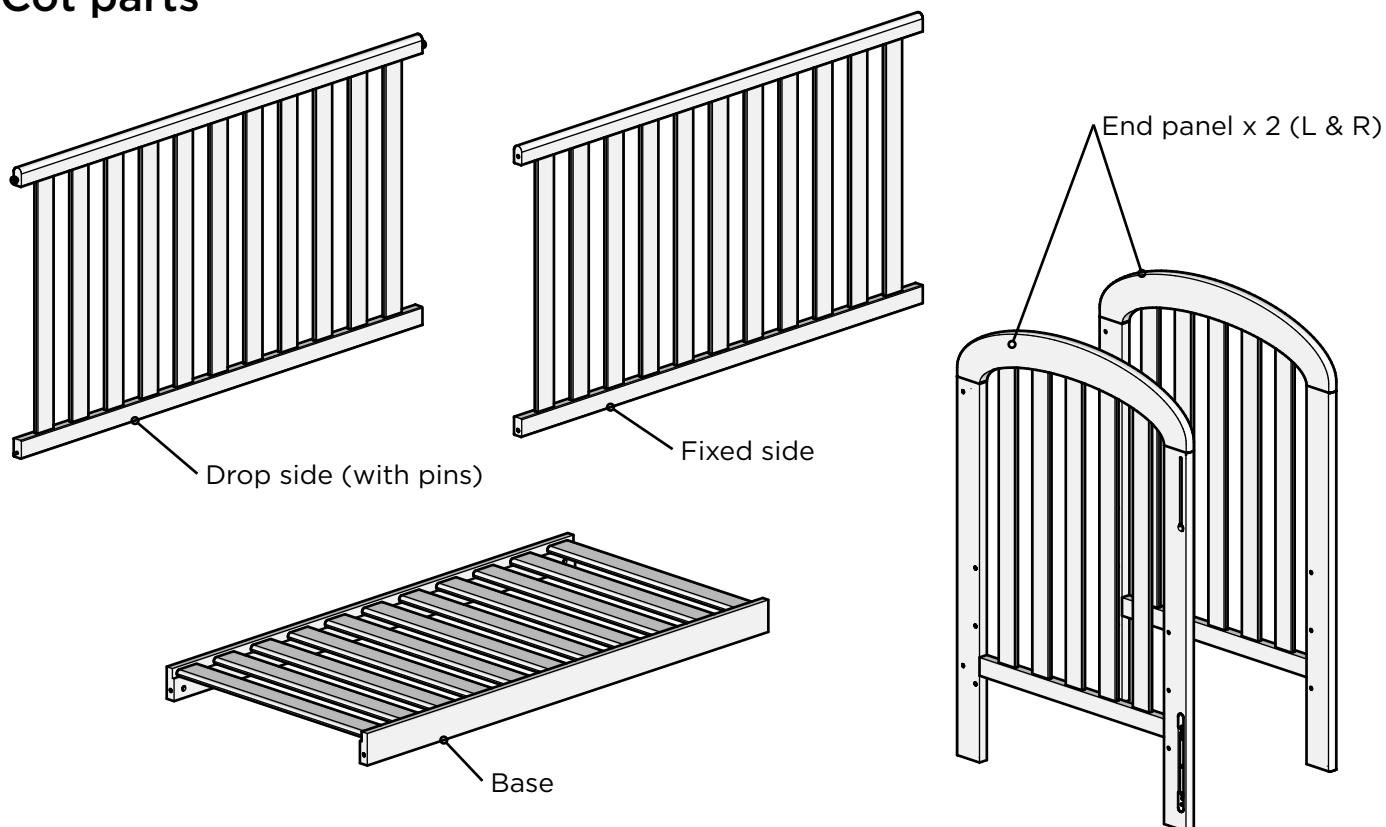

Hardware

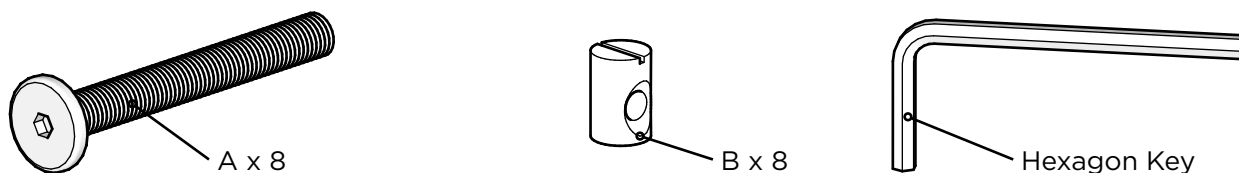

Assembly 1

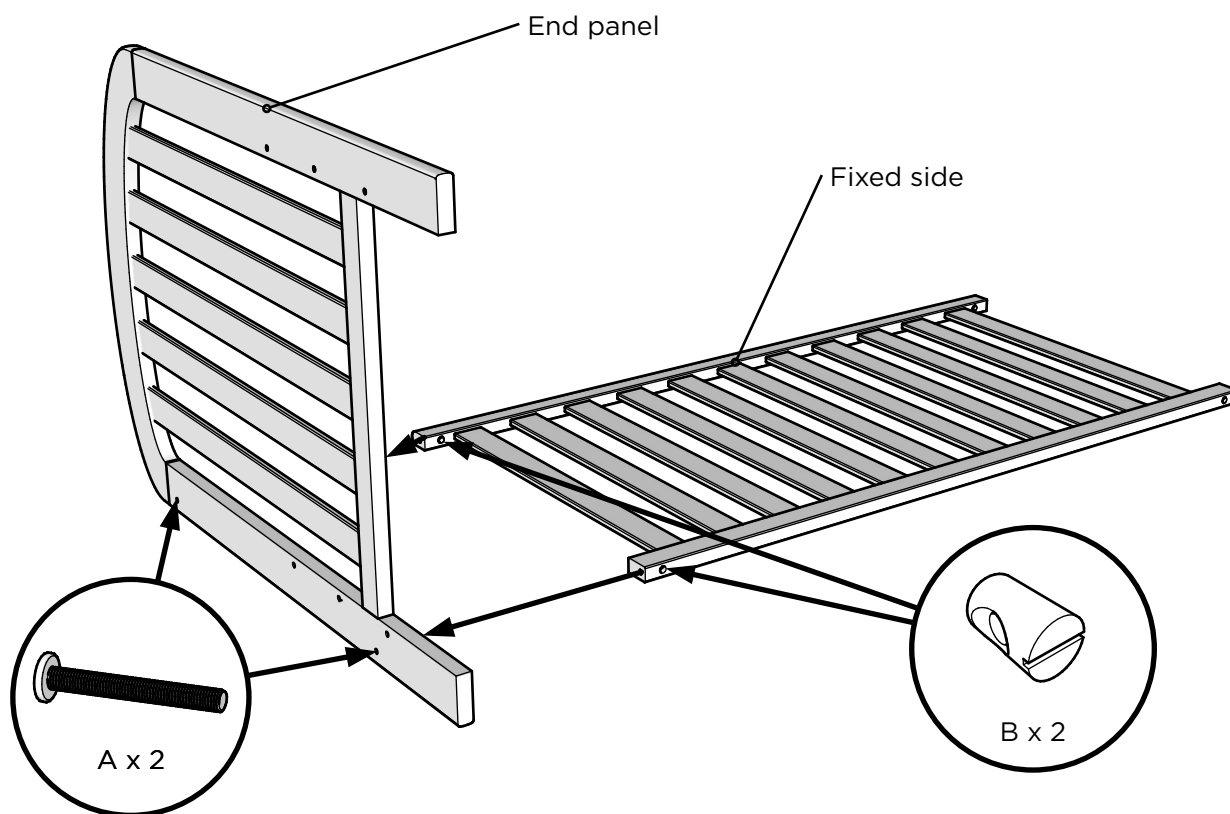

NOTE: Ensure slot in B is visible when inserted into the Side.

Assembly 2

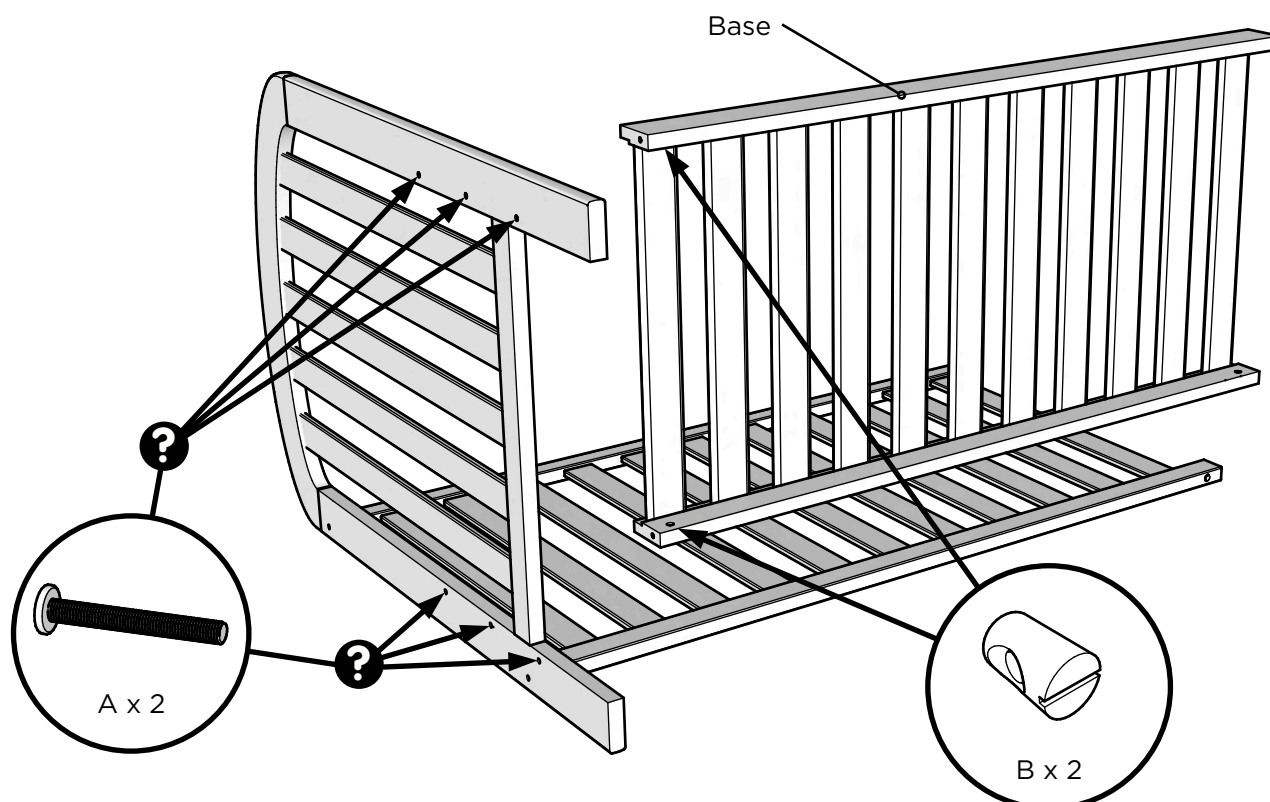

NOTE: The lowest base position is the safest and should always be used in that position as soon as the baby is old enough to sit up.

NOTE: Ensure slot in B is visible when inserted into the Base.

Assembly 3

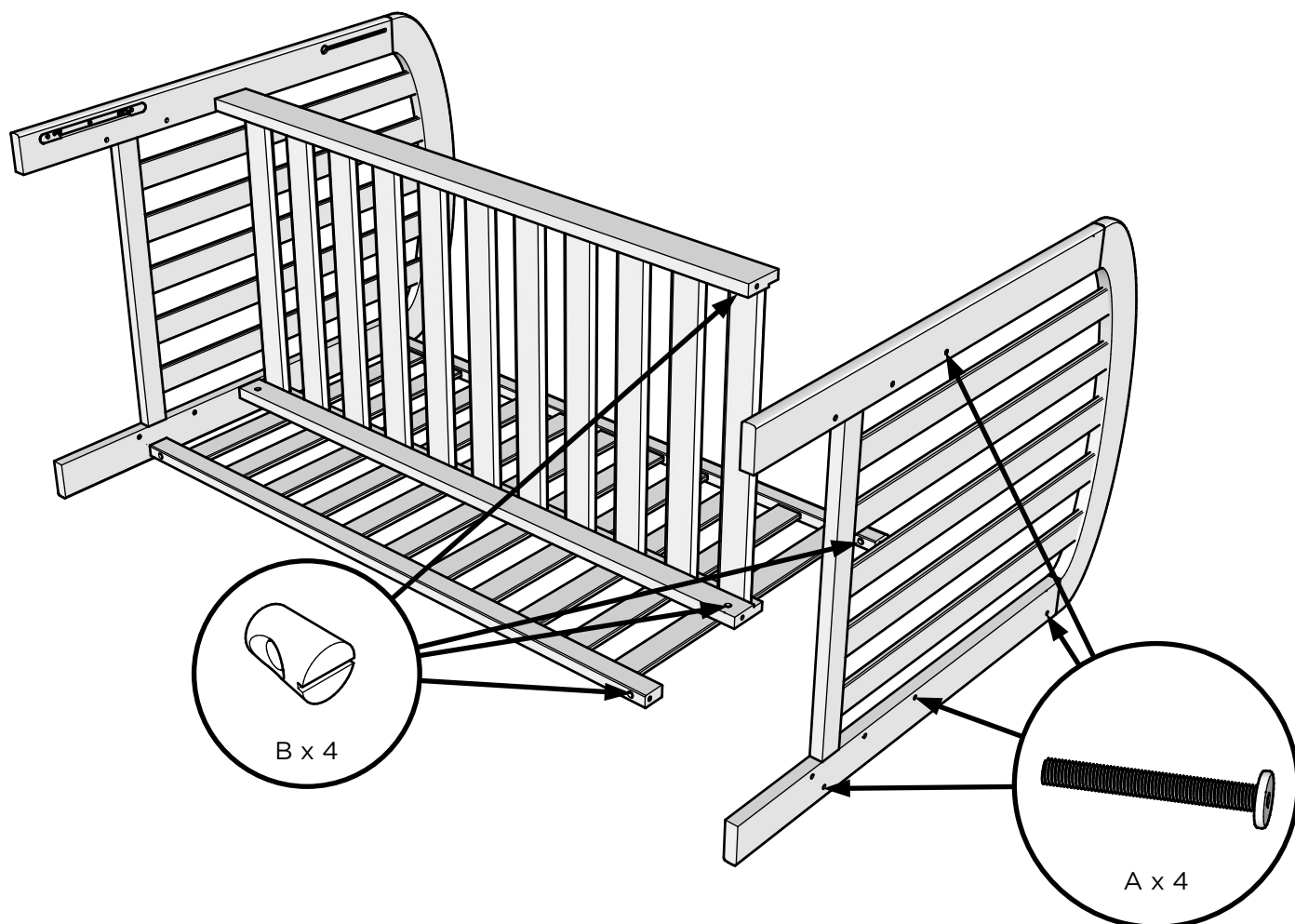

NOTE: Do not tighten bolts fully at this stage.

Assembly 4

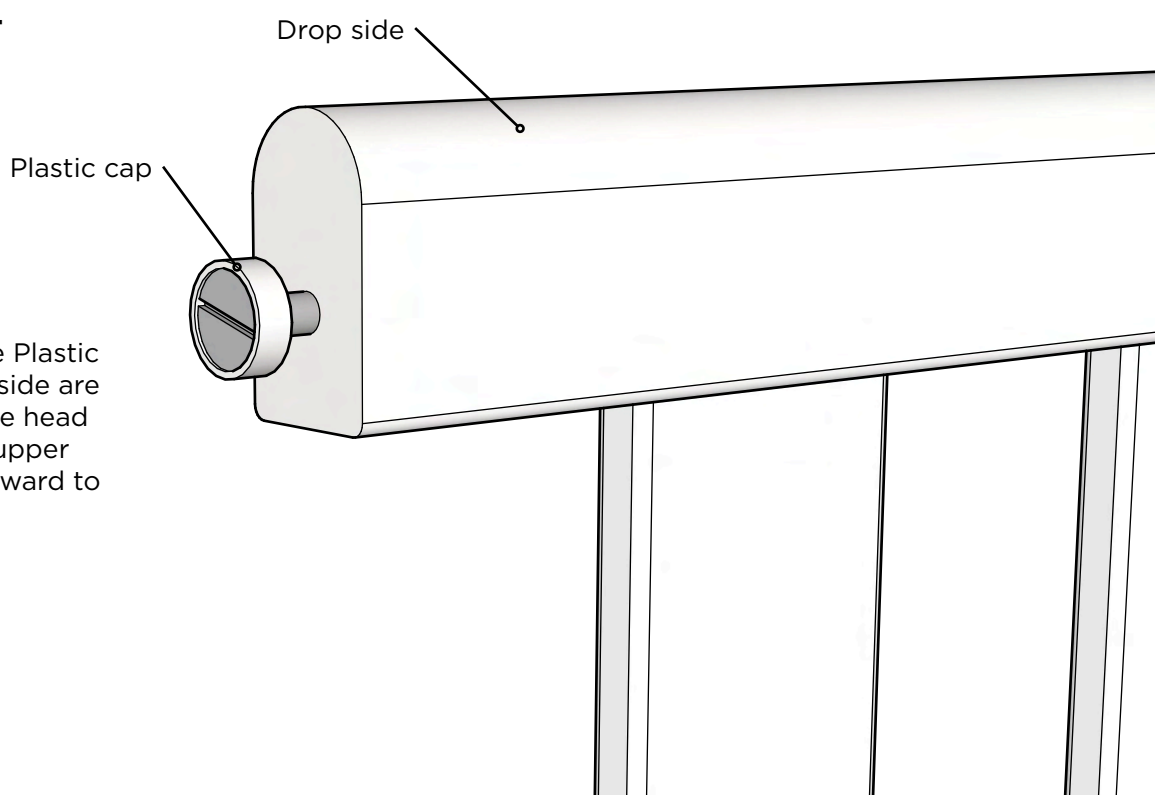

IMPORTANT:
Make sure that the Plastic caps on the Drop side are in position over the head of the pins in the upper rail. If not, pull outward to clip into place.

Assembly 5

Ease the cot ends apart and making sure that the plastic caps remain in place, fit the top end pins of the Drop side fully into the lower end of the top slot in each End panel, as shown.

End panel

Drop side

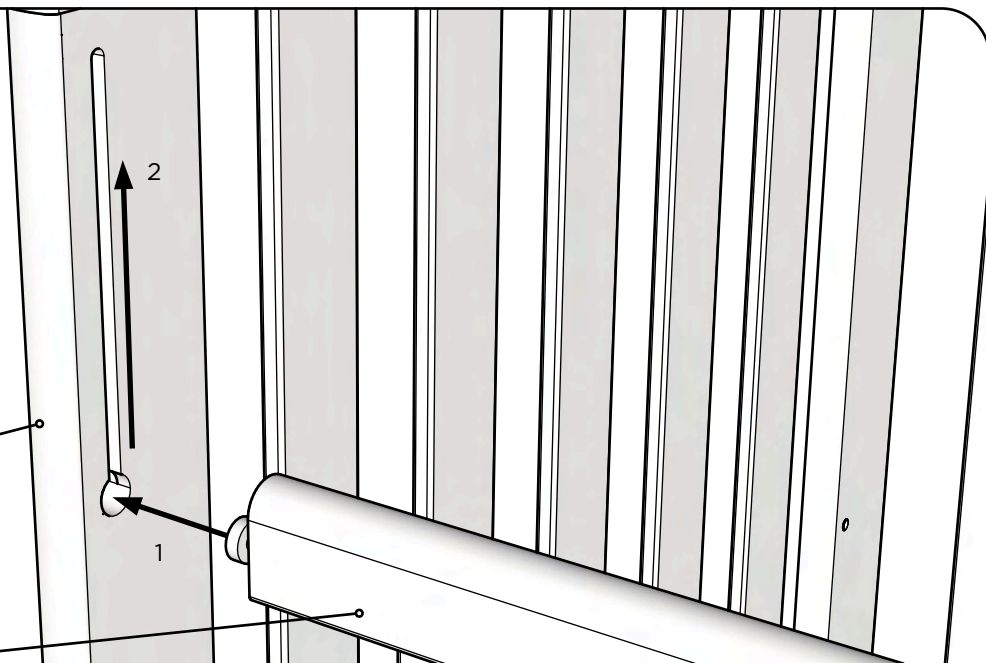

Assembly 6

Raise the Drop side to align the lower end pins with the lower grooves as shown.

Push the lower pins in against the spring pressure and locate them in the slots. The help of an assistant will make this stage easier. Push all parts tightly together and fully tighten all bolts. Your cot is now ready for use.

NOTE:

Take care when locating pins into lower grooves as the pin can easily damage the surface finish.

End panel

Drop side

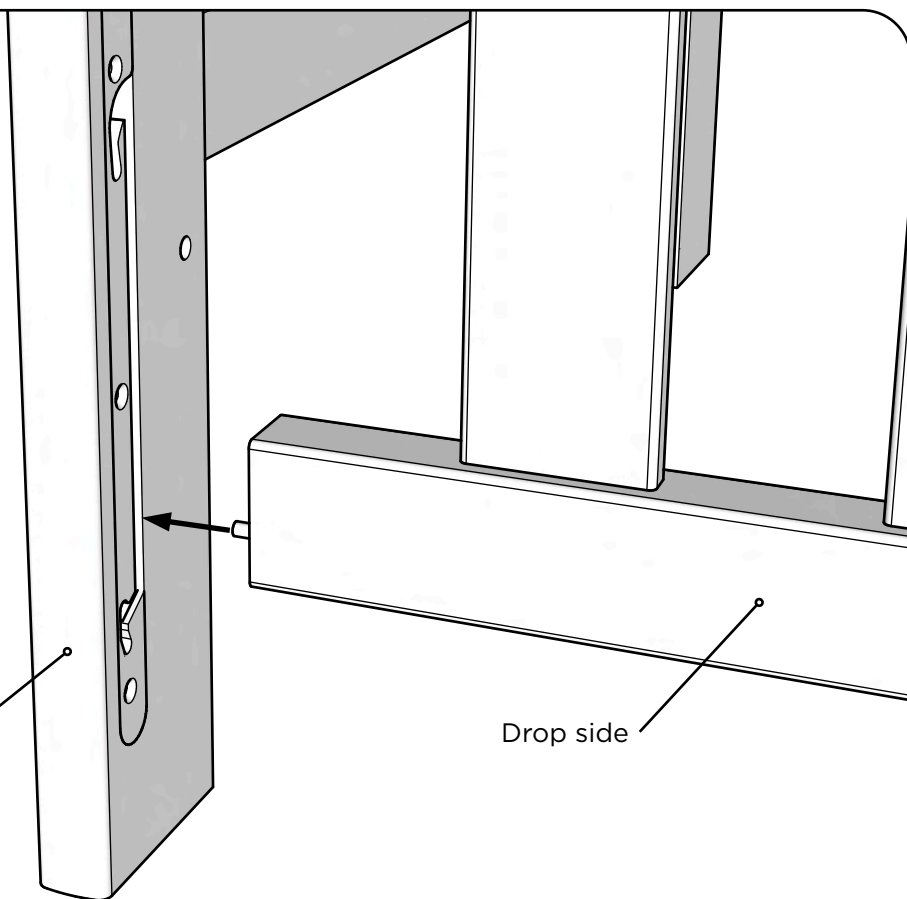

To operate the Drop side:

Grasp the top rail in the centre and lift slightly.

Press the bottom of the Drop side in with your leg - this will disengage the locks and allow the side to drop. To raise the side, lift the Drop side slightly, push the bottom rail inward with your leg then lift again until the Drop side clicks into place.

IMPORTANT: Always grasp the top rail in the centre to ensure that both locks engage and disengage.

A light application of furniture polish to the slots in the end panels will help ensure smooth operation of the Drop side.

Care and maintenance

All assembly fittings should be tightened properly and should be checked regularly and re-tightened as necessary. Take care when moving the furniture, as careless handling may cause damage.

Cleaning is simple; just wipe over with a damp cloth, and avoid using strong detergents or abrasives.

An occasional light application of a wax polish will help maintain the finish.

In use

WARNING: YOUR CHILDREN'S SAFETY IS YOUR RESPONSIBILITY

If you leave the child unattended in the cot, always make sure that the dropside is in the raised position.

The base can be adjusted in height, but the lowest position is the safest and should always be used in that position as soon as the baby is old enough to sit up.

This product is suitable for a mattress of 1200mm long and 600mm wide.

Check the length and width of the mattress, to ensure the gap between the mattress and the sides and ends does not exceed 30mm.

The maximum thickness of the mattress is 100mm.

Check the thickness of the mattress, to ensure that the internal height (surface of the mattress to the upper edge of the cot frame) is at least 500mm in the lowest position of the cot base and at least 200mm in the highest position of the cot base.

To prevent injury from falls, the cot should no longer be used for the child once they are able to climb out of the cot.

This product has been designed and manufactured to: BS EN 716-1:2017.

Warning: Do not use the cot if any part is broken, torn or missing and use only spare parts approved by the manufacturer.

Warning: Do not leave anything in the cot or place the cot close to another product, which could provide a foothold or present a danger of suffocation or strangulation, e.g. strings, blind/curtain cords, etc.

Warning: Do not use more than one mattress in the cot.

Warning: Be aware of the risk of open fires and other sources of strong heat, such as electric bar fires, gas fires, etc. near the vicinity of the cot.

This product can be dismantled carefully for storage and transportation.



For customer care or enquiries:

Call: 01692 408802

Email: nursery@east-coast.co.uk

East Coast Nursery Ltd. Robertson House, North Walsham,
Norfolk, NR28 0BX

eastcoastnursery.co.uk

4364
09_17